

PL1446

NO.	DESCRIPTION	NO.	DESCRIPTION
1	WHEEL COVER	41	UPPER HANDLE
2	NUT M8	42	BOLT M6×30
3	FRONT WHEEL	43	ROPE GUIDE
4	FRONT WHEEL SHAFT ASSEMBLY	44	NUT M6
5	ADJUSTABLE CONNECTING ROD	45	STOP CABLE
6	NUT M6	46	FOAM PIPE
7	BOLT M5×16	47	BOLT M6×35
8	REAR SHAFT CLAMP (R)	48	BRAKE LEVER
9	CLIP NUT	49	ENGINE
10	REAR AIR DUCT	50	BOLT M8×16
11	SCREW ST4.8×16	51	REAR COVER SUPPORT
12	SCREW ST6.3×16	52	CABLE SUPPORT
13	REAR WHEEL COVER	53	RIGHT BRACKET
14	NUT M10	54	NUT M8
15	REAR WHEEL	55	DECK
16	HEIGHT ADJUSTMENT SPRING	56	BOLT M8×16
17	SHAFT SLEEVE	57	NUT M8
18	REAR WHEEL SHAFT ASSEMBLY	58	REAR SHAFT CLAMP (L)
19	NUT M6	59	NUT M6
20	HEIGHT ADJUSTMENT HANDLE	60	BELT COVER
21	BOLT M6×14	61	BOLT M6×10
22	FABRIC BAG	62	SCREW ST4.8×16
23	SCREW ST4.8×16	63	GRASS BOARD
24	FABRIC BAG SUPPORT	64	SCREW ST4.2×14
25	HANDLE	65	BOLT M8×25
26	REAR COVER	66	INCH BOLT 3/8-24×39
27	REAR COVER SHAFT	67	DISHED WASHER
28	TORSION SPRING	68	BLADE
29	LOCK RING	69	KNIFE HOLDER
30	MULCHING PLUG	70	BOLT M8×16
31	BOLT M8×40	71	BOTTOM PLATE
32	PUSH ROD INSULATION BLOCK	72	SCREW ST4.8×16
33	KNOB	73	FRONT SHAFT CLAMP PLATE
34	WASHER Ø12×Ø24×2	74	FRONT FACE
35	LOWER HANDLE	75	SCREW ST6.3×16
36	BOLT M8×44	76	NUT M14X1.5
37	KNOB 2	77	WATER INLET
38	FABRIC BAG PLASTIC COVER	78	O-RING
39	PLASTIC COVER HANDLE	79	LEFT BRACKET
40	INDICATED BOARD		

ENGINE FOR PL1241, PL1446, PL1446S

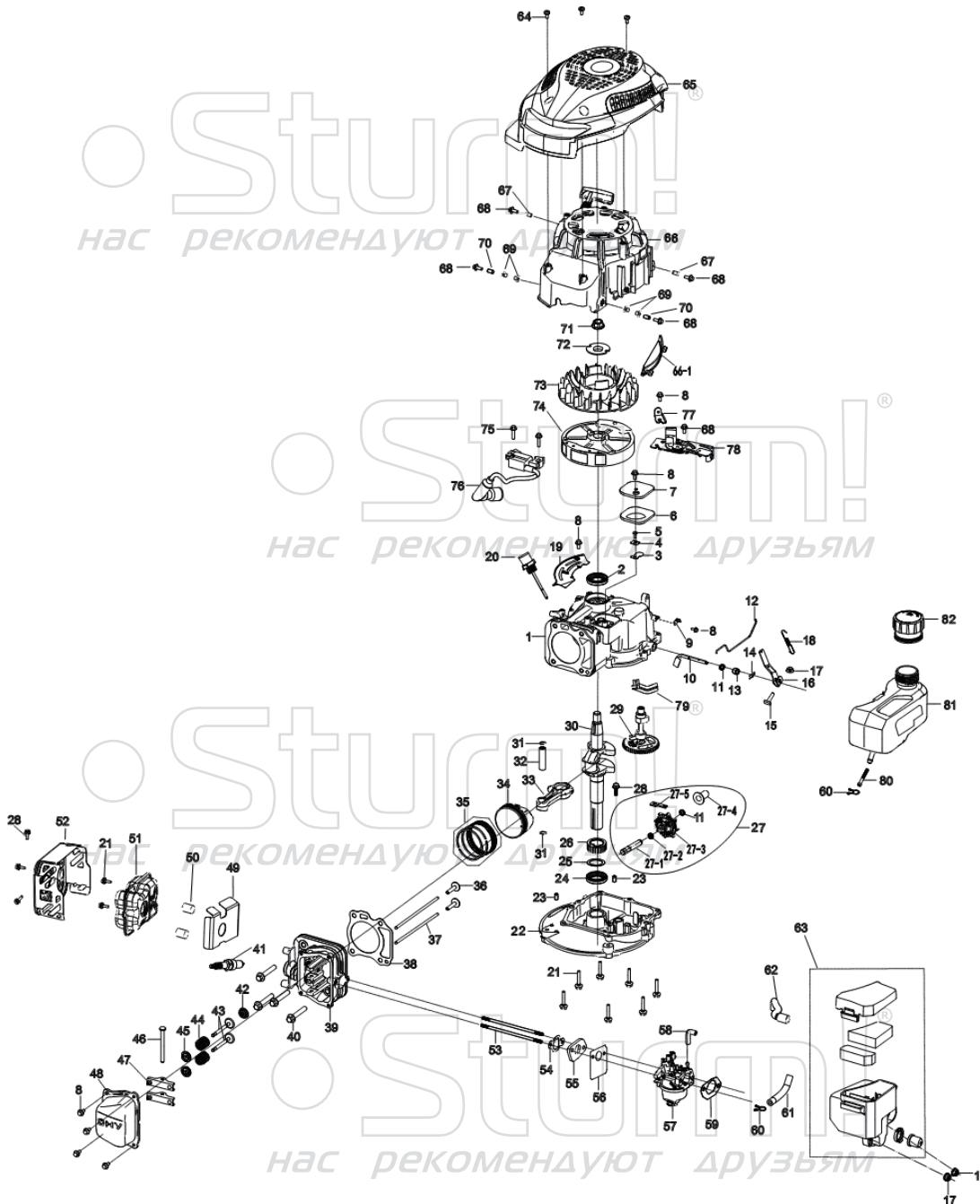

NO.	DESCRIPTION	NO.	DESCRIPTION
1	CRANKCASE	40	BOLT M8X50
2	OIL SEAL	41	SPARK PLUG
3	VALVE ELEMENT	42	OIL SEAL
4	LIMIT PLATE	43	VALVE
5	SCREW M4×6	44	SPRING
6	GASKET OF RESPIRATOR COVER	45	SPRING SEAT
7	RESPIRATOR COVER PLATE	46	SHAFT
8	BOLT M5X12	47	VALVE ROCKER ARM
9	THROTTLE CONTROL GROUP	48	CYLINDER HEAD COVER
10	SPEED REGULATOR ROCKER SPINDLE	49	GASKET OF MUFFLER
11	WASHER Φ6	50	BUSHING
12	SPEED ADJUSTMENT LEVER	51	MUFFLER ASSY
13	OIL SEAL	52	MUFFLER COVER ASSY
14	SPRINGNESS SPLIT PIN	53	DOUBLE BOLT M6×96
15	T-BOLT	54	PAPER GASKET OF INLET PIPE
16	SPEED REGULATOR ROCKER	55	HEAT INSULATION GASKET
17	NUT M6	56	PAPER GASKET
18	SPRING	57	CARBURETOR
19	BACK PLATE	58	OIL PIPE 1
20	LUBRICATING GAUGE	59	GASKET
21	BOLT M6X30	60	OIL PIPE CIRCLIP
22	CRANKCASE COVER	61	OIL PIPE 2
23	PIN Φ8×12	62	EXHAUST PIPE
24	OIL SEAL	63	AIR FILTER
25	WASHER Φ25.5×Φ34.5×1	64	SCREW ST5×15
26	GEAR	65	ENGINE HOOD ASSEMBLY
27	RATE-LIMITING GEAR ASSY	66	HAND STARTING ASSEMBLY
27-1	GEAR SHAFT	66-1	WIND DEFLECTOR
27-2	WASHER Φ6	67	BUSHING 1
27-3	RATE-LIMITING GEAR	68	BOLT M5X20
27-4	SLIDING SLEEVE	69	BUSHING 2
27-5	PRESSURE PLATE	70	BUSHING 3
28	BOLT M6X12	71	NUT M14X1.5
29	CAM ASSY	72	STARTER CUP BASE
30	CRANKSHAFT	73	FAN
31	SPRING	74	FLYWHEEL ASSEMBLY
32	PISTON PIN	75	BOLT M5X25
33	CONNECTING ROD ASSY	76	IGNITION
34	PISTON	77	HOOD SUPPORT LUGS
35	PISTON RING ASSY	78	BRAKE ASSY
36	TAPPET	79	OIL RETURN BLOCK
37	GUIDE BOARD OF HANDSPIKE	80	OUTLET NOZZLE STRAINER
38	SEAL GASKET	81	TANK
39	CYLINDER HEAD ASSY	82	FUEL TANK CAP

PL1241/PL1446/PL1446S-EX-KMSK03P2024027ST